

HDMI Matrix (Router Type)

Model No. SX-MX04



Features

- 4 HDMI inputs and 4 HDMI outputs.
- Fully HDMI routing function.
- Support resolution up to 1080p
- Supports 30/36bit deep color display.
- 4 IR emitters to control the 4 sources, the IR control is routing type
- Mounting ears supplied to fix the unit to hidden place
- Intelligent EDID setting function.
- USB upgrading function.
- Support 3D video format
- Compact size

Dear customer:

Thank you for purchasing this product. For optimum performance and safety, please read these instructions carefully before connecting, operating or adjusting this product. Please keep this manual for future reference.

Notice

Our reserves the right to make changes in the hardware, packaging and any accompanying documentation without prior written notice.

WARNING:

TO REDUCE THE RISK OF FIRE, ELECTRIC SHOCK OR PRODUCT DAMAGE:

- 1) DO NOT EXPOSE THIS APPARATUS TO RAIN, MOISTURE, DRIPPING OR SPLASHING AND THAT NO OBJECTS FILLED WITH LIQUIDS, SUCH AS VASES, SHALL BE PLACED ON THE APPARATUS.
- 2) DO NOT INSTALL OR PLACE THIS UNIT IN A BOOKCASE, BUILT-IN CABINET OR IN ANOTHER CONFINED SPACE. ENSURE THE UNIT IS WELL VENTILATED.
- 3) TO PREVENT RISK OF ELECTRIC SHOCK OR FIRE HAZARD DUE TO OVERHEATING, DO NOT OBSTRUCT THE UNIT'S VENTILATION OPENINGS WITH NEWSPAPERS, TABLECLOTHS, CURTAINS, AND SIMILAR ITEMS.
- 4) DO NOT INSTALL NEAR ANY HEAT SOURCES SUCH AS RADIATORS, HEAT REGISTERS, STOVES, OR OTHER APPARATUS (INCLUDING AMPLIFIERS) THAT PRODUCE HEAT.
- 5) DO NOT PLACE SOURCES OF NAKED FLAMES, SUCH AS LIGHTED CANDLES, ON THE UNIT.
- 6) CLEAN THIS APPARATUS ONLY WITH DRY CLOTH.
- 7) UNPLUG THIS APPARATUS DURING LIGHTNING STORMS OR WHEN UNUSED FOR LONG PERIODS OF TIME.
- 8) PROTECT THE POWER CORD FROM BEING WALKED ON OR PINCHED PARTICULARLY AT PLUGS.
- 9) ONLY USE ATTACHMENTS/ACCESSORIES SPECIFIED BY THE MANUFACTURER.
- 10) REFER ALL SERVICING TO QUALIFIED SERVICE PERSONNEL.

TABLE OF CONTENTS

Introduction

Package Contents

Descriptions

Connect and Operation

Specification

Typical Application

INTRODUCTION

This Foxun True 4x4 HDMI Matrix is a economical version routing type matrix. This new matrix is fully HDMI V1.3b supported. An EDID learning function is added to increase its capability of compatible. You can remote control the sources from the sink side via a extended receiver. So that you can configure the system much easier than using simple point to point IR connection. To fix the matrix to certain places such as ceiling or wall, a mounting ears are also supplied in the package

PACKAGE CONTENTS

1. Main unit. SX-MX04.
2. 5VDC Power Supply.
3. 1x Remote.
4. 4x IR-TX extension cable.
5. 4x IR-RX extension cable.
6. 4xIR receiver cable extender jacks
7. Operating Instructions.

PANEL DESCRIPTIONS

Front panel

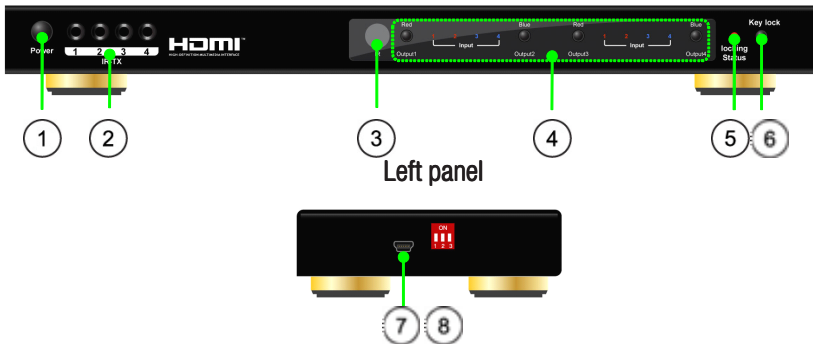

1. Power switch.
2. IR TX out 1 TO 4.
3. IR window.
4. Output selection and indicator of input for output port 1 to 4.
5. Key lock button.
6. Indicator of locking status, when the output selection buttons are locked, LED inside lit.
7. USB port for ISP.
8. DIP switch.

Rear panel

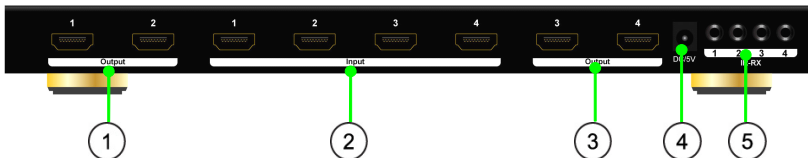

1. Output 1 and 2 with HDMI.
2. Input ports 1 to 4 with HDMI.
3. Output 3 and 4 with HDMI.
4. Power input.
5. IR extension 1 to 4.

CONNECT AND OPERATION

- 1) Connect the HDMI input sources (such as HD-DVD, PS3, STB etc) into SX-MX04.
- 2) Connect the HDMI outputs (such as HD-LCD, HD-DLP) into SX-MX04.
- 3) Connect the IR RX receiving cable into SX-MX04 extension and connect The IR TX cable into SX-MX04 emitter.
- 4) Power on the input source you want to show. (Keep the unused input power off, otherwise it may interfere the normal display.)
- 5) Connect the power supply into SX-MX04 and turn on the display you want to watch.
- 6) Use remote or push the button to choose input source. Extra infrared receiver extension, IR emitter, are supplied for remote control.
- 7) The IR signal of any IR extension will through "TX IR" port to send the signal out.

SOURCE-SINK AUTOFIT Function

This function applies to the situation when the source's HDMI version exceeds the sink's HDMI version. (This function can be used to fix the deepcolor, 1080P, 1080i, 2ch audio, multi channel audio issue.)

For example: When the TV is HDMI 1.2 version and PS3 source is HDMI 1.3 version, it will output HDMI 1.2 version.

(1) Under default mode, this machine will output 1.2 version HDMI signal(1080P and stereo audio).

(2) Under button mode.

There are two mode to update the EDID data according to the DIP setting. When the DIP is in default mode (0,0,0), the matrix will be in mix mode .

A、 When the source is HDMI1.3, (e.g., HDMI output from PS3), OUTPUT1 to 4 both support HDMI1.3 displays, press "selection of OUTPUT1" and "lock key" simultaneously, the machine will output HDMI1.3 signals.

B、 When the source is HDMI1.3, (e.g., the HDMI output from PS3), OUTPUT 1 to 4 are connected to the displays that can only support HDMI 1.2 MAX, press "selection of OUTPUT1" and "lock key" simultaneously (no matter whether HDMI OUTPUT port is connected to the display that supports HDMI 1.3 or not), it will output HDMI 1.2 signals.

When the DIP is in default mode (0,0,0), the matrix will be in copy mode .

Note: The method to reset the machine to default EDID setting: Disconnect the input and output. Please press "selection of OUTPUT1" and "lock key" Simultaneously for at least 3 seconds, and EDID of all the four input ports will be reset to the default setting. The audio setting of the default EDID is stereo. It is suitable for TV sets.

9) DIP switch setting

| Position ID | | | |
|-------------|---|---|---|
| 1 | 2 | 3 | |
| 0 | 0 | 0 | Mix the low version EDID.(default) (note 1) |
| 0 | 0 | 1 | reserved |
| 0 | 1 | 0 | reserved |
| 0 | 1 | 1 | reserved |
| 1 | 0 | 0 | Copy the EDID of the display which connected the OUTPUT1.(note 2) |
| 1 | 0 | 1 | reserved |
| 1 | 1 | 0 | reserved |
| 1 | 1 | 1 | reserved |

Note1: The matrix will mix the EDID data of the sink devices. The mixed EDID data will use the lowest resolution of the video and the least channel number of the audio. For example, some sink device support 1080P, some sink device only support 1080i, some support 5.1 audio, but some only support stereo. Then the mixed EDID will be 1080i and stereo.

Note2: If user wants to just use one sink device's EDID data, this DIP setting can be used.

Attention:

Please insert or extract cables gently.

SPECIFICATIONS

| | |
|-----------------------------|---|
| Operating Temperature Range | -5 to +35°C (-41 to +95°F) |
| Operating Humidity Range | 5 to 90%RH (No Condensation) |
| Video Amplifier Bandwidth | 140MHz |
| Input Video Signal | 0.5-1.0 Volts P-P |
| Input DDC Signal | 5 volts p-p(TTL) |
| Data transfer speed rate | 6.75Gbps(Maximum) |
| Support Video Format | DTV/HDTV:480i/576i/480P/576P/720P/1080i/1080P 3D video |
| HDMI Output | HDMI 1.3 |
| Support Video Color Format | xv-YCC/deep color 36bit |
| Support Audio Format | DTS-HD Master Audio、Dolby true-HD etc. |
| Transmission Distance | 15m(Maximum)over standard HDMI cable/26AWG |
| Power consumption | 12watts(Maximum) |
| Dimension (L×W×H) | 290x100x26mm |
| Net Weight | 850g |
| Gross Weight | 1570g |
| Gift box measurement | L39xW21.5xH9cm |
| Master carton measurement | L44*W40*H29cm 6PCS/CTN |

***Note: Specifications are subject to change without notice. Mass and dimensions are approximate.**

IR receiver cable extender jacks.

When the display device is not near to the matrix, the IR_RX cable will be too short. There are a pair of jacks to extend the IR_RX cable. Customer or installer can use the headphone cable or 4-line telephone cable to form the IR cable extender.

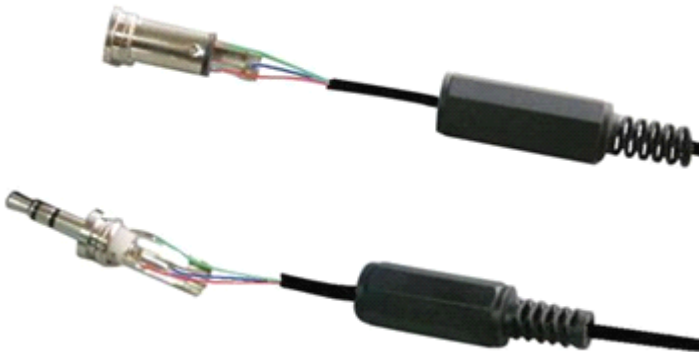

TYPICAL APPLICATION

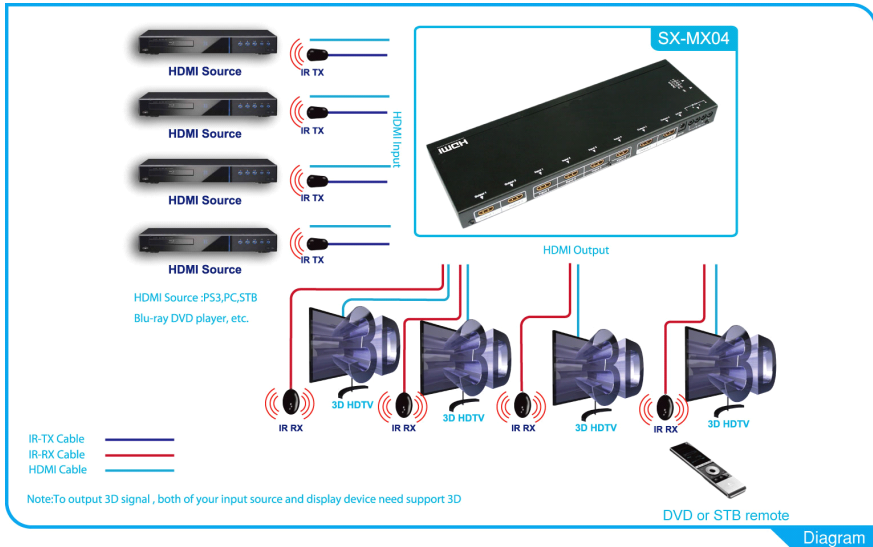

MAINTENANCE

Clean this unit with a soft, dry cloth. Never use alcohol, paint thinner or benzene to clean this unit.